

## USING AC ADAPTER (OPTION)

Using the optional dedicated AC adapter (model:AC-230CZ) for the CITIZEN blood pressure monitor (CH-452) allows you to measure your blood pressure without having to worry about the amount of remaining charge in the batteries.)



### Warning

The CH-452 and AC-230CZ should be used indoors in dry location.

- 1 Insert the AC adapter plug into the socket on the blood pressure monitor.**

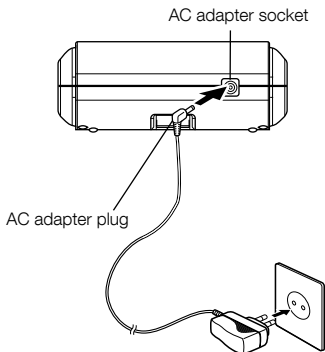

- 2 Plug the AC adapter into a mains power outlet.**

- If you plan to use the AC adapter for an extended period of time, remove the batteries. If the batteries are left in the compartment, electrolyte may leak from the batteries and cause a fault in the blood pressure monitor.
- When only batteries are used to supply power to the monitor, the AC adapter should be unplugged from the monitor. Leaving the AC adapter plugged into the blood pressure monitor could cause a malfunction.
- Plug the AC adapter into the socket, where you can easily plug off soon and safely in times of trouble.

The dedicated AC adapter (model:AC-230CZ) for the CH-452 is optional. The AC adapter is available from retailers stocking CITIZEN digital blood pressure monitors.